

Installation Instructions: Floodlight (10700-10717)

Date	Revision
1.6.2022	2

Read these instructions before installation and retain for future reference
This equipment should be installed by a competent electrician



Important Information

We recommend that luminaires are installed by a qualified electrician ensuring the installation complies with current IEE wiring regulations BS7671:2018 & local building control.

- BELL will not accept responsibility for any claims arising from a poor installation.
- The light source of this luminaire is not replaceable: when the light source reaches end of life, the whole luminaire must be replaced.
- Always switch off mains supply before installing.
- Ambient Temperature -25°C to +25°C.
- External use only.

This product may contain substances that can be hazardous to the environment if not disposed of properly. Electrical and electronic equipment should never be disposed of with general household waste but must be separated for its correct treatment and recovery. Where possible recycle your packaging.

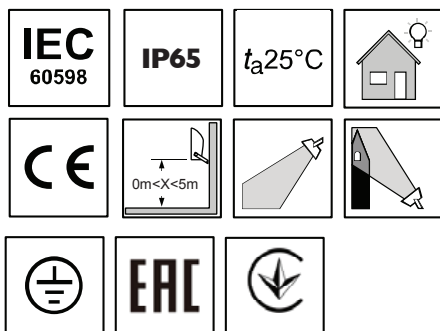

Technical Helpline +44 (0)1924 893380

www.belllighting.co.uk

Type	CCT (K)	Power(W)	LEDs	Lumen Output (lm)	Dimension (mm)	S.C. (m²)	kg	Voltage	Frequency	Surge rating
10700	4000	10	15	800	102x132.5x21.5	0.013	0.25	220-240V ~	50/60Hz	1KV/2KV
10702	4000	20	30	1600	116x148.5x23	0.017	0.36			
10704	4000	30	45	2400	145x177x23	0.028	0.65			
10706	4000	50	75	4000	209x248x23	0.053	1.11			

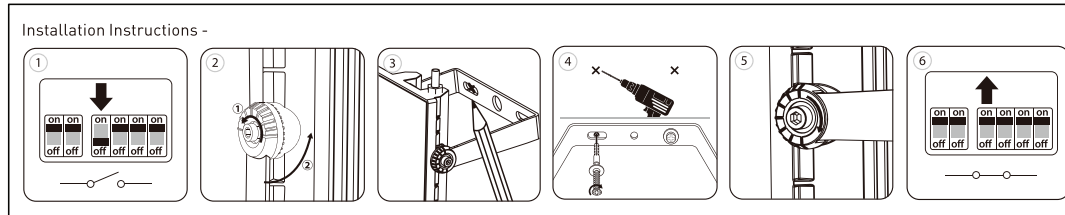
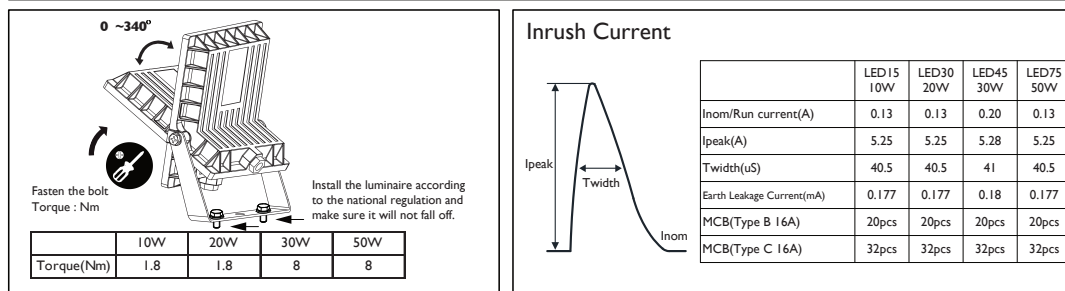
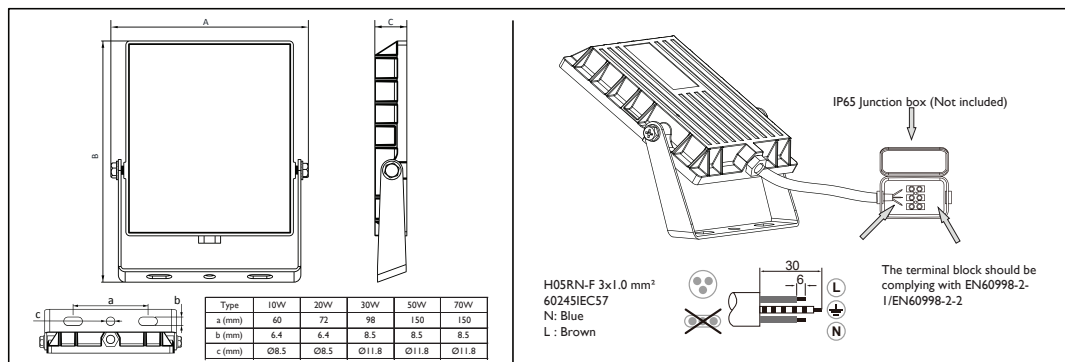

PIR Version

Operation Modes

Automatic operation:

- The light will turn on when walking through detection range (see below)
- The light will turn off after 60s when there is no movement detected

Manual Over-ride

- Turn the unit on for 5 seconds and switch off-on twice in 2 seconds. The unit will stay on, bypassing the sensor.
- Turn off the unit for 10 seconds, the unit will be back to automatic operation mode

Detection Range

