

Cleaning:

- > Clean this hand dryer only with a soft dry cloth
- > Do not use any chemical or abrasive cleaners.

Specifications:

Voltage:	240V~ / 50Hz
Rated Power:	2500W
Current:	11.4A
Ingress Protection:	IPX1
Volume of air movement:	270m³/h
Air Speed:	30ms ⁻¹
Dimensions:	564 x 315 x 380mm
Unit weight:	5.5kg

Eventually, you may want to replace this light fitting:

When your light fitting comes to the end of its life or you choose to update or upgrade it by replacing it, please do not dispose of it with your normal household waste, please recycle where facilities exist. When you need to dispose of this fitting, check with your retailer or local authority for suitable options. New regulations require the recycling of Waste from Electrical and Electronic Equipment (European "WEEE Directive" effective August 2005—UK WEEE Regulations effective 2nd January 2007). Environment Agency Registered Producer: WEE/GA0248QZ



If you experience problems:

If your product is defective or develops a fault, please return it to the place where you bought it. You can call our Helpline for advice. The Helpline will gladly give advice on any aspect of any Eterna Lighting product but may not be able to give specific instructions regarding individual installations.

If in doubt, consult a qualified electrician.

Help line:

Tel: 01933 673 144 Fax: 01933 678 083 Email: sales@eterna-lighting.co.uk

For answers to frequently asked questions (FAQs) and other information visit our web-site

www.eterna-lighting.co.uk



IMPORTANT !

Safety and Installation instructions

Automatic Hand Dryer 2.5kW

Model(s)
SSHDA-2500

Pack contents:

Automatic Hand Dryer	1
Fixing pack	1
Hex drive key	1

**PLEASE READ THESE INSTRUCTIONS BEFORE
INSTALLING YOUR NEW FITTING**

- -

PLEASE RETAIN FOR FUTURE REFERENCE

Read this first:

- > **This Hand Dryer must be installed in accordance with the Building Regulations.** These may be obtained from HMSO or viewed and downloaded from www.communities.gov.uk following the link for Building Regulations.
- > **If in any doubt, consult a qualified electrician.**
- > Switch off the mains before commencing installation and remove the appropriate circuit fuse.
- > Do not use the dryer without the front cover fitted.
- > Disconnect the dryer from the electrical supply before flash or high voltage testing.
- > Suitable for indoor use only.
- > **WARNING: This product becomes hot!**
- > This product is not intended to be used by children and persons with sensory, physical and/or mental impairments that would prevent them from using it safely.
- > This product is suitable for installation on surfaces with normal flammability (indicated by the "F" in a triangle) e.g. wood, plasterboard, masonry. It is not suitable for use on highly flammable surfaces (e.g. polystyrene, textiles).
- > Before making fixing hole(s), check that there are no obstructions hidden beneath the mounting surface such as pipes or cables.
- > The chosen location of your new fitting should allow for the product to be securely mounted and safely connected to the mains supply.
- > The dryer must be positioned so that there is at least 0.8m (800mm) between the air outlet and the surface beneath.
- > If the location of your new fitting requires the provision of a new electrical supply, the supply must conform with the requirements of the Building Regulations—see above.
- > This product is designed for permanent connection to fixed wiring via a fused spur (with a 13 Amp fuse). We recommend that the supply incorporates a switch for ease of operation.
- > Make connections to the electrical supply in accordance with the following code:
 - Live - Brown or Red
 - Neutral - Blue or Black
 - Earth - Green and Yellow
- > This product must be connected to Earth.

- > You are advised at every stage of your installation to double-check any electrical connections you have made. After you have completed your installation there are electrical tests that should be carried out: these tests are specified in the Wiring Regulations (BS7671) referred to in the Building Regulations. If in doubt, consult a qualified electrician.

Installation:

- 1) Select the location of your new dryer with consideration to the conditions listed above.
- 2) Remove the hexagonal drive screws from the base of the dryer using the key supplied—see fig. 1.
- 3) Mark the location of the fixing holes using either the back of the dryer as a template or by measuring out using the diagram opposite—see fig. 2.
- 4) Secure the back of the dryer to the wall using the fixings supplied. If the fixings supplied are not suitable to your installation, please select suitable alternatives.
- 5) Make the supply connections according to the colour code above.
- 6) Temporarily restore the power supply—beware parts of the motor that are live and that are accessible to touch.
- 7) Move your hands beneath the sensor to replicate hand drying movement. The dryer should operate when you move your hands beneath the sensor and stop when your hands are withdrawn.
- 8) If the dryer does not respond correctly, you can adjust the sensitivity of the sensor by turning the screw shown in fig. 3 opposite.
- 9) Turn off the power at the mains.
- 10) Replace the cover and secure using the two hexagonal drive screws supplied. Tighten securely using the key supplied.
- 11) Restore the power.

Fig. 1.

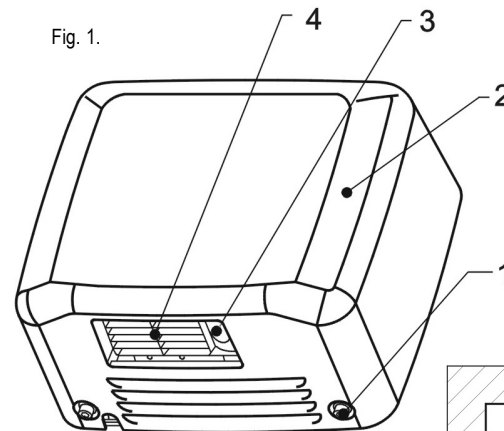

KEY:

- 1—Cover screw
- 2—Cover
- 3—Sensor
- 4—Warm air outlet grille
- 5—Plastic wall plug
- 6—Back of dryer
- 7—Fixing screw
- 8—Sensitivity adjustment
- 9—Cable entry hole
- 10—Mains terminal
- 11—Hexagonal drive key

Fig. 3.

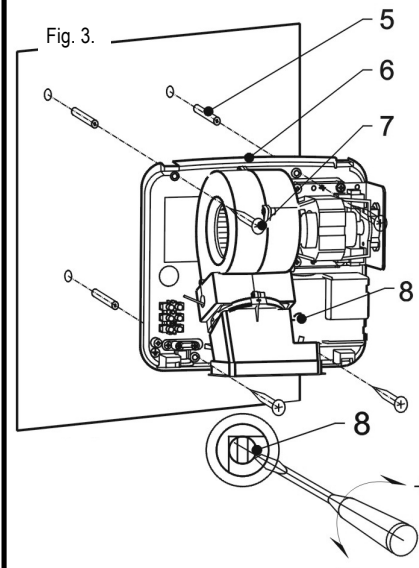
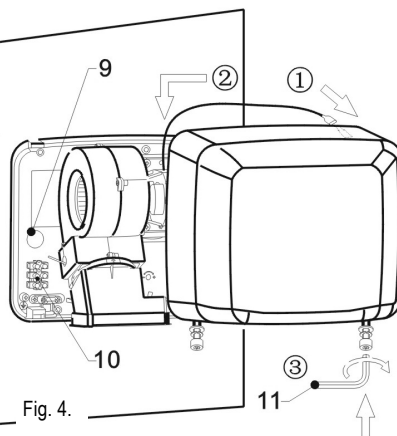
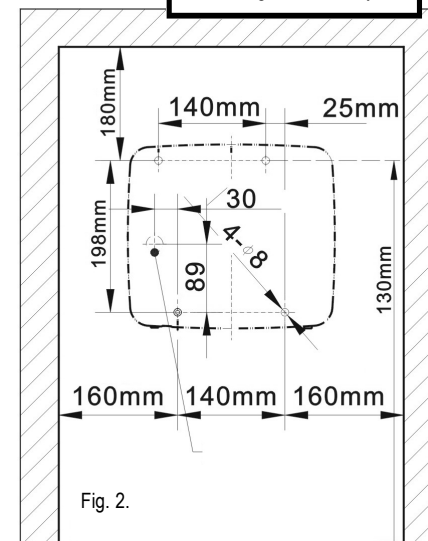

Fig. 2.



Safety markings:



IPX1—Drip proof