

CATALOGUE RANGE: ■ EMERGENCY

Versatile fitting offering 4 different fixing options for maximum flexibility and long term performance.

Fitting shown with ISOMMOLR

**Eterna**  
Everyday Lighting For Professionals



LED MULTI FIXING EXIT SIGN

- Polycarbonate construction
- Comes complete with 4 fixing options - ceiling mounted, end mounted, wall mounted and suspended (adjustable length 1m suspension cable included)
- Supplied with a double-sided up arrow ISO 7010 format exit legend - full range of alternative legend directional panels available separately including signs directive format
- 3 hour maintained mode as standard which can also be configured for non-maintained or remote switched operation
- Viewing distance 30m
- LED charge light and battery test button
- Additional recessed option available with EXITREC

EXITREC

- Hole cut out size: 360mm x 65mm

- **Fitting** = M.O.M: 1 / O.P.Q: 6
- **Legends** = M.O.M: 1 / O.P.Q: 100
- **EXITREC** = M.O.M: 1 / O.P.Q: 25

See  
Page 2  
For Installation  
Quick Guide

Code	Colour	Wattage	Colour Temp.	Luminaire Lumens
EXITMMO	White	2.8W	6000K	35 lm (mains) / 25 lm (battery)
EXITREC	White Recessed Mounting Kit			
ISOMMOLR	ISO 7010 Left/Right Arrow Legend			
ISOMMOD	ISO 7010 Down Arrow Legend			
EMMOUP	Signs Directive Up Arrow Legend			
EMMOD	Signs Directive Down Arrow Legend			
EMMOLR	Signs Directive Left/Right Arrow Legend			



EXITMMO comes complete with ISO 7010 up arrow legend

**EternaPro**  
**LED**  
**5 YEAR**  
Warranty\*

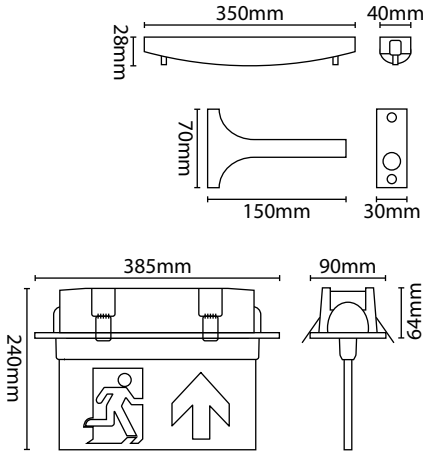
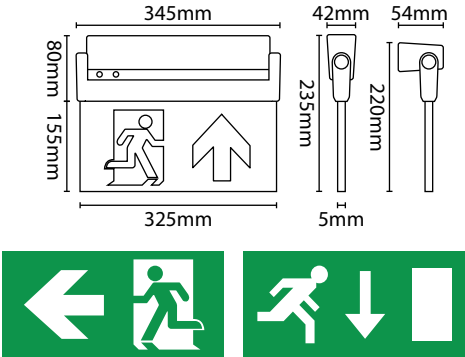

Suspension kit included



Wall mount included



Recessed mounting kit available separately EXITREC

\*Subject to terms & conditions

# Quick Guide Mounting Instructions



1) Suspension kit is in 2 parts - cable and ceiling mount



2) Screw the base of the barrel to the top cover of the fitting

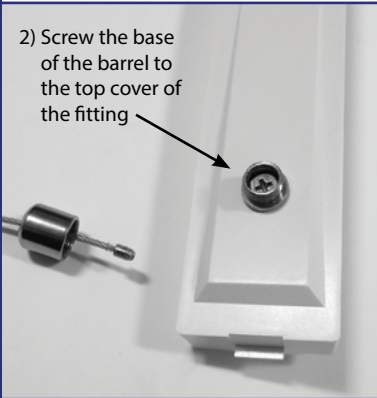

3) Secure barrel in place with the nut supplied



4) Attach the top of the barrel to base of the barrel



5) Feed the suspension cable through the ceiling mount

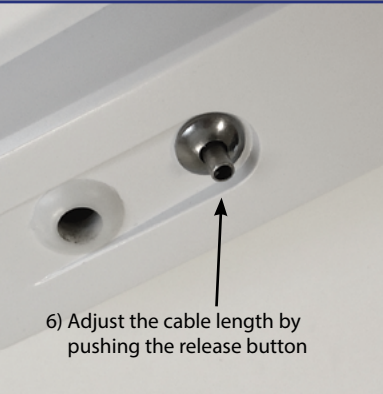
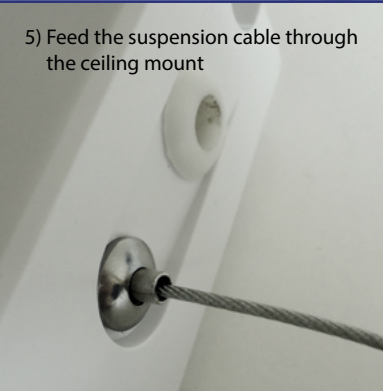

6) Adjust the cable length by pushing the release button

7) Attach the ceiling mount to desired area

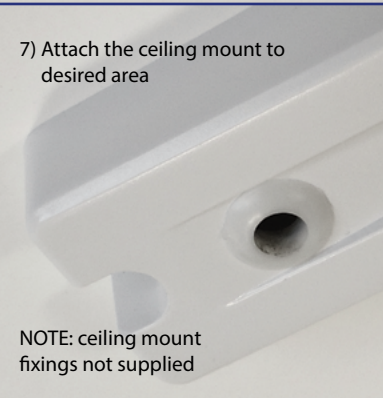

NOTE: ceiling mount fixings not supplied

## WALL MOUNT (INCLUDED)



1) Ensure wall mount is this way up when attaching to a wall

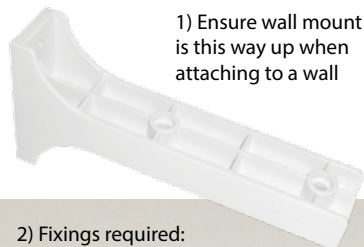

2) Fixings required:

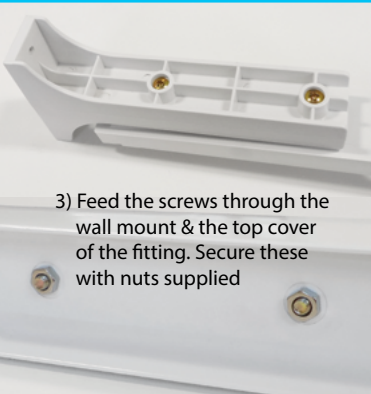

3) Feed the screws through the wall mount & the top cover of the fitting. Secure these with nuts supplied



4) Re attach the top cover of the fitting and secure with the screw that was removed earlier

## RECESSED MOUNTING KIT (EXITREC)



Recessed mounting kit (EXITREC)

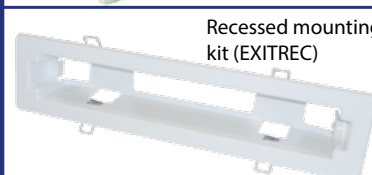

1) Cut a 360mm x 65mm fixing hole ensuring the hole is cut accurately



2) Fit EXITREC into the fixing hole using it's retaining clips

3) Push the EXITMMO into the EXITREC until it is secured in place



NOTE: the charge and test buttons are still visible with the EXITREC on



## DIRECT MOUNTING

The top of the fitting rotates 45° so it can be mounted directly to a ceiling or wall.

